

Revised Record

1.0

New issue

2008-12-02

INTERFACE	
1	AO
2	/CS2
3	/CS1
4	/RD
5	R/W
6	VDD
7	VSS
8	DB0
9	DB1
10	DB2
11	DB3
12	DB4
13	DB5
14	DB6
15	DB7
16	/RST
17	V0
18	VEE
19	LED-A
20	LED-K

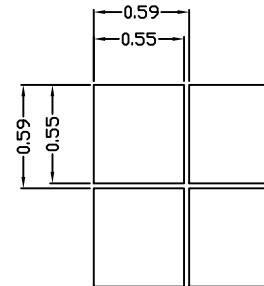
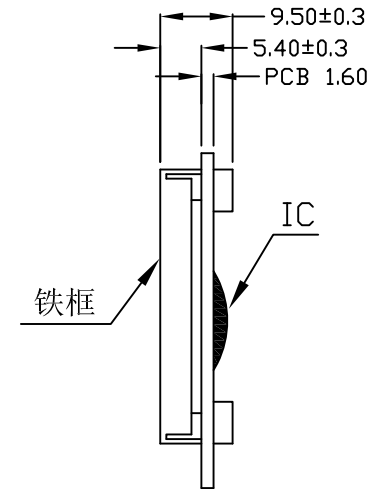
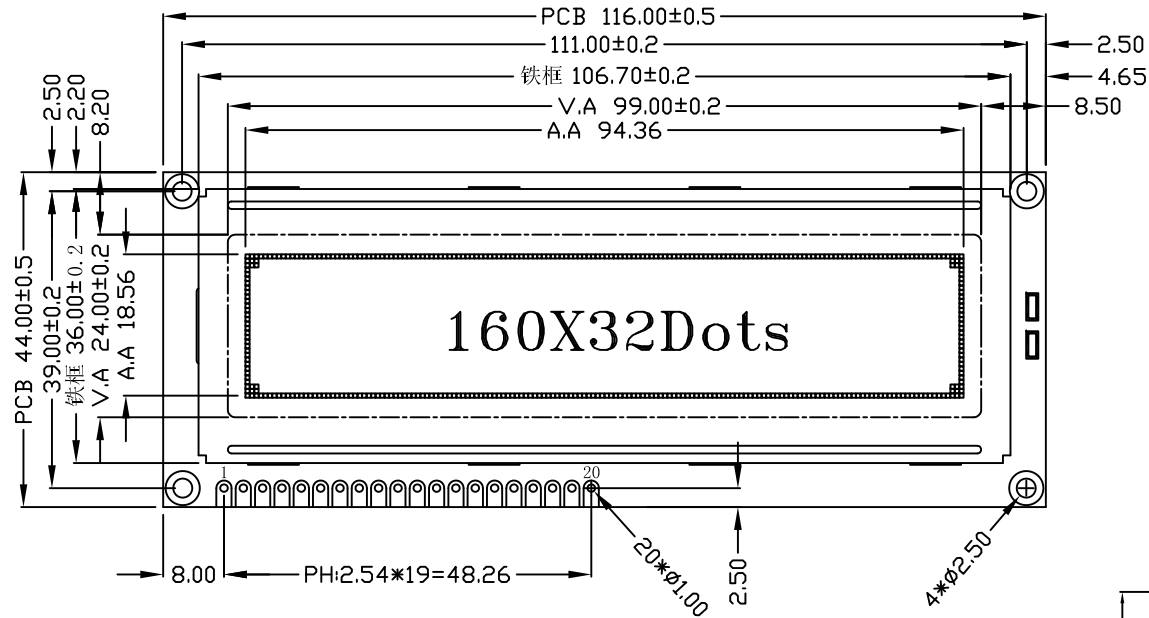

DOT SIZE:

Customer's Choices:

DISPLAY TYPE:	
View angle:	
Temp:	
Voltage:	
IC:	
Backlight:	
Other:	

NOTES:

- | | |
|----------------------------|------------------------------------|
| 01. DISPLAY TYPE: | STN/POSITIVE(GRAY)/REFLECTIVE RoHS |
| 02. OPERATING VOLTAGE: | VOP=6.5V,VDD=5.0V |
| 03. OPERATING TEMPERATURE: | -20°C~+70°C |
| 04. STORAGE TEMPERATURE: | -30°C~+80°C |
| 05. DRIVE MODE: | 1/32DUTY,1/9BIAS |
| 06. VIEWING DIRECTION: | 6:00 |
| 07. DRIVE IC: | SBN1661G(OR-EQV) |
| 08. CONNECTOR: | ZEBER |
| 09. BACKLIGHT: | LED(WHITE) |
| 10. CUSTOMER'S PART ID: | BLAZE_STANDARD_PRODUCT |

BLAZE Blaze Display Technology Co.,Ltd.

DESIGNED BY: BDT-21

BGB16032-02-SERIES

VERSION: 1.0

CHECKED BY: BDT-06

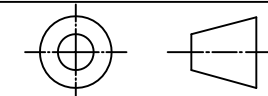

PAGE 1 OF 1

APPROVED BY: BDT-01

UNIT: mm

Website: <http://www.blazedisplay.com>

DATE: 2008-12-02