

Revised Record

1.0 New Issue

2015-05-15

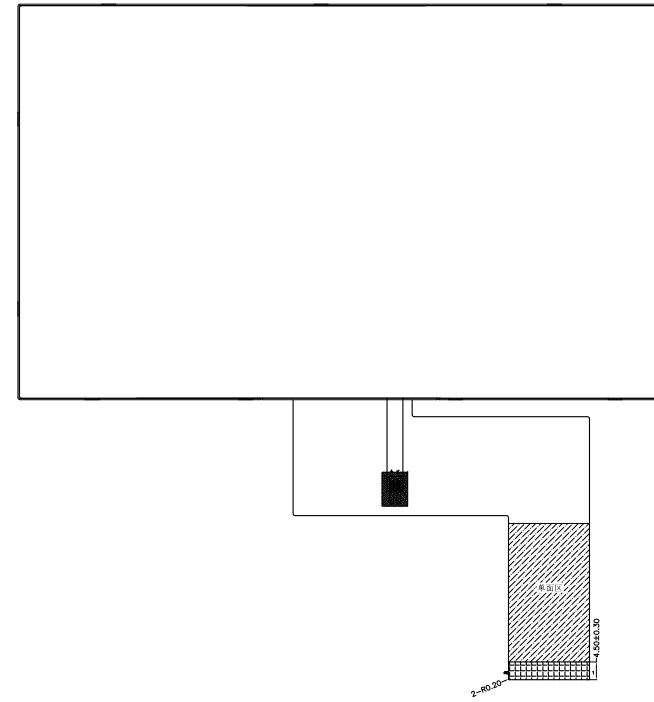
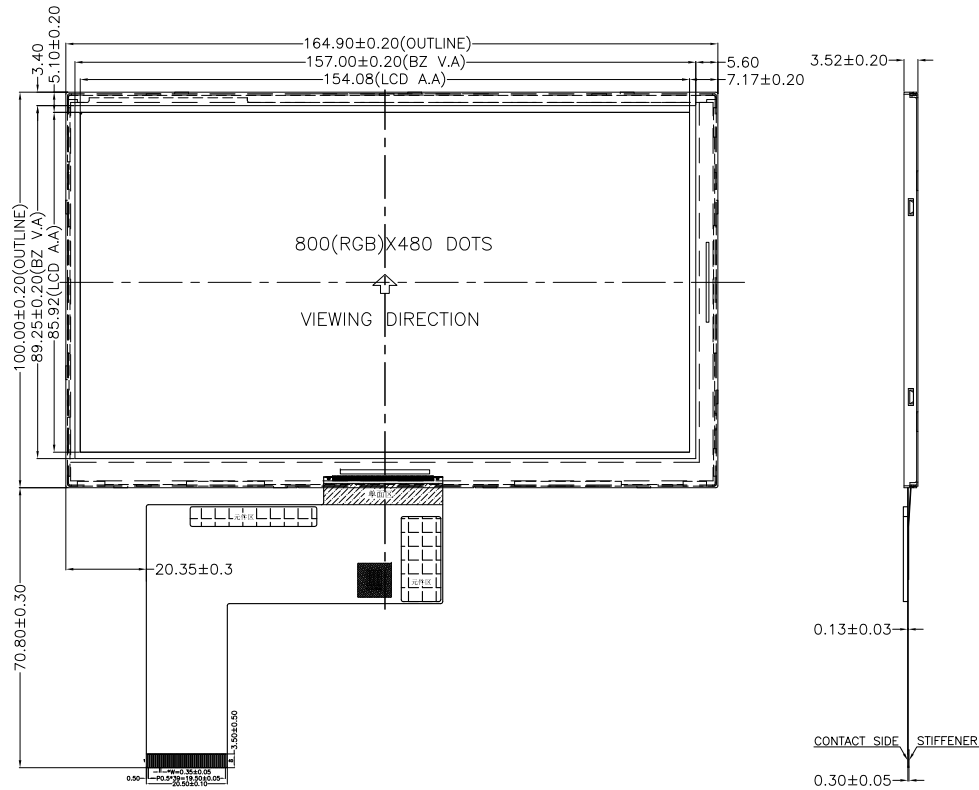

PIN	Symbol
1	LED_K
2	LED_A
3	GND
4	VDD
5	R0
6	R1
7	R2
8	R3
9	R4
10	R5
11	R6
12	R7
13	G0
14	G1
15	G2
16	G3
17	G4
18	G5
19	G6
20	G7
21	B0
22	B1
23	B2
24	B3
25	B4
26	B5
27	B6
28	B7
29	GND
30	DCLK
31	DISP
32	HSYNC
33	VSYNC
34	DE
35	NC
36	GND
37	XR
38	YD
39	XL
40	YU

背光电路:

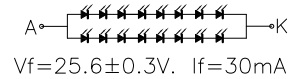

BLAZE Blaze Display Technology Co.,Ltd.

DISPLAY TYPE:	7.0" TFT	DISPLAY DRIVER:	ST5623-G3-1&ST5091-G3-1	PIXEL PITCH:	0.1926 X 0.179 mm
POLARIZER MODE:	TRANSMISSIVE	OPERATING TEMP:	-20°C TO +70°C	BACK LIGHT:	LED WHITE(X16),8串*2并
VIEWING DIRECTION:	12 O'CLOCK	STORAGE TEMP:	-30°C TO +80°C		
Dot matrix:	800(RGB)X480 DOTS	STRUCTURE:	LCD+IC+FPC+BL	MATERIAL NOTE	ROHS REQUEST

DESIGNED BY: BDT-23

BDT-T7040-01-SERIES

VERSION: 1.0

CHECKED BY: BDT-09

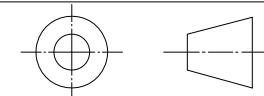

PAGE 1 OF 1

APPROVED BY: BDT-05

UNIT: mm

Website: <http://www.blazedisplay.com>

DATE: 2015-05-15