

Revised Record

1.0

New issue

2015-03-13

INTERFACE

1	VSS
2	VDD(5V)
3	V0
4	RS
5	RW
6	E
7	DB0
8	DB1
9	DB2
10	DB3
11	DB4
12	DB5
13	DB6
14	DB7
15	LED-A(5V)
16	LED-K
17	VH+
18	VH-

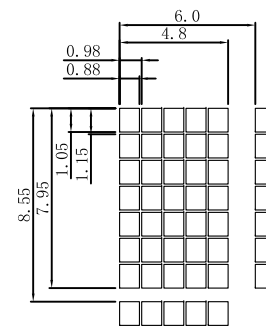
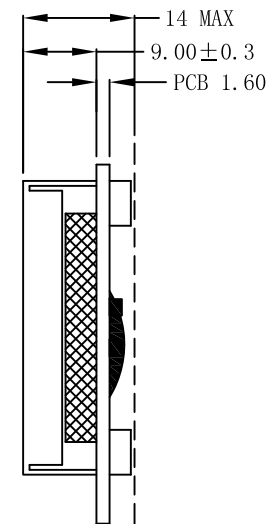
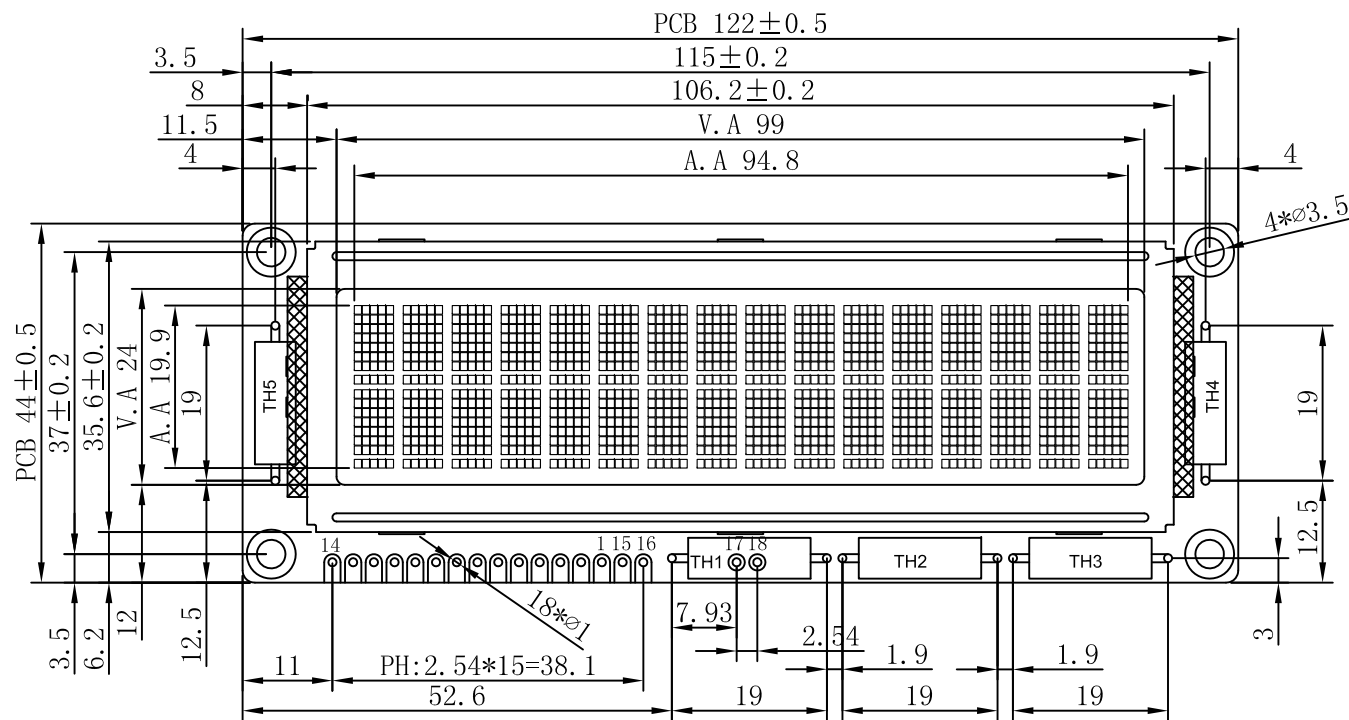

DOT SIZE:

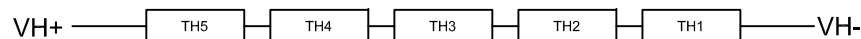

NOTES:

- 01. DISPLAY TYPE: STN(YELLOW-GREEN)/POSITIVE/TRANSFLECTIVE RoHS
- 02. OPERATING VOLTAGE: VOP=4.8V,VDD=5.0V
- 03. OPERATING TEMPERATURE: -20°C~+70°C
- 04. STORAGE TEMPERATURE: -30°C~+80°C
- 05. DRIVE MODE: 1/16DUTY,1/5BIAS
- 06. VIEWING DIRECTION: 6:00
- 07. DRIVE IC: AIP31066(EQV.)
- 08. CONNECTOR: ZEBER
- 09. BACKLIGHT: LED(Y-G),I=80MA,SUNLIGHT\_READABLE
- 10. CUSTOMER'S PART ID: BLAZE\_STANDARD\_PRODUCT

**BLAZE** Blaze Display Technology Co.,Ltd.

DESIGNED BY: BDT-29

**BCB1602-11-SERIES**

VERSION: 1.0

CHECKED BY: BDT-07

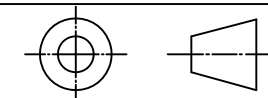

PAGE 1 OF 1

APPROVED BY: BDT-02

UNIT: mm

Website: <http://www.blazedisplay.com>

DATE: 2015-03-13