

PIN	1	2	3	4	5	6	7	8
NAME	VDD	VSS	V0	RS	R/W	E	DB0	DB1
PIN	9	10	11	12	13	14	15	16
NAME	DB2	DB3	DB4	DB5	DB6	DB7	LEDA	LEDK

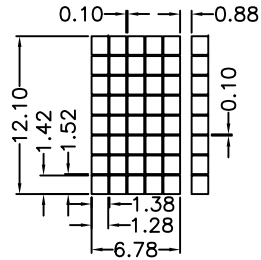

NOTES:

- |                           |                                     |
|---------------------------|-------------------------------------|
| 1. DISPLAY TYPE:          | STN/Negative/Transmissive/Blue RoHS |
| 2. OPERATING VOLTAGE:     | VDD=5.0V                            |
| 3. OPERATING TEMPERATURE: | 0°C~+50°C                           |
| 4. STORAGE TEMPERATURE:   | -20°C~+70°C                         |
| 5. DRIVE MODE:            | 1/16Duty,1/5Bias                    |
| 6. VIEWING DIRECTION:     | 12:00                               |
| 7. DRIVE IC:              | SPLC780D                            |
| 8. BACKLIGHT:             | LED (White)                         |
| 9. CUSTOMER No.:          |                                     |

**BLAZE** Blaze Display Technology Co.,Ltd.

DESIGNED BY: BDT-36

**BCB0801-03**

VERSION: 1.0

CHECKED BY: BDT-07

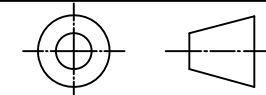

PAGE 1 OF 1

APPROVED BY: BDT-02

UNIT: mm

Website: <http://www.blazedisplay.com>

DATE: 2007-01-18