

Pin	Pin Name
1	LED_A
2	LED_K
3	SPI3W/SPI4W
4	VDD
5	GND
6	CS
7	RST
8	SDA
9	SCL
10	D/C

backlight circuit



VF=3.1V(TYP);IF=15mA

**BLAZE** Blaze Display Technology Co.,Ltd.

DISPLAY TYPE:	1.44" TFT	DISPLAY DRIVER:	ST7735S	PIXEL PITCH:	0.1992 X 0.207 mm
POLARIZER MODE:	TRANSMISSIVE	OPERATING TEMP:	-20°C TO +70°C	BACK LIGHT:	LED WHITE(X1), parallel
VIEWING DIRECTION:	12 O'CLOCK	STORAGE TEMP:	-30°C TO +80°C		
Dot matrix:	128(RGB)X128 DOTS	STRUCTURE:	LCD+IC+FPC+BL	MATERIAL NOTE	ROHS REQUEST

DESIGNED BY: BDT-23

BDT-T14410-01-SERIES

VERSION: 1.0

CHECKED BY: BDT-09

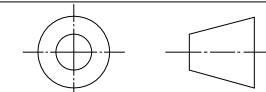

PAGE 1 OF 1

APPROVED BY: BDT-05

UNIT: mm

Website: <http://www.blazedisplay.com>

DATE: 2015-03-13