

Revised Record

1.0 New Issue

2013-08-01

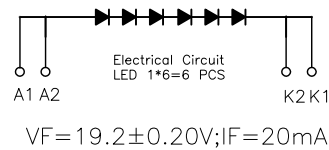
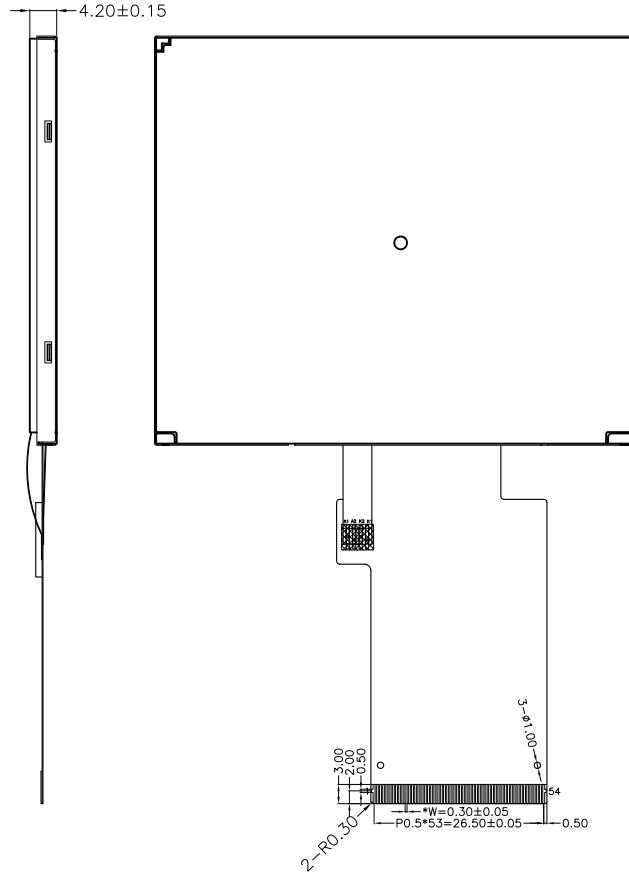
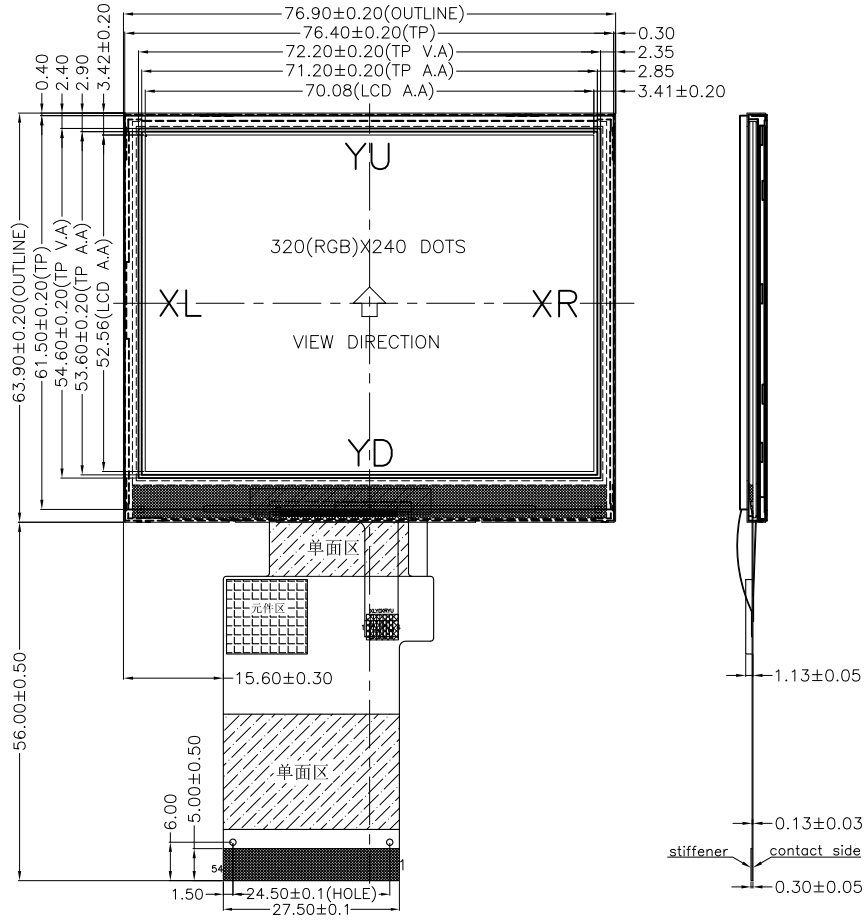

PIN	PIN NAME	PIN	PIN NAME
1	VBL-	28	R0
2	VBL-	29	R1
3	VBL+	30	R2
4	VBL+	31	R3
5	YU	32	R4
6	XR	33	R5
7	NC	34	R6
8	/RESET	35	R7
9	SPENA(nCS)	36	HSYNC
10	SPCLK(SCL)	37	VSYNC
11	SPDAT(SDI)	38	DCLK(DOTCLK)
12	B0	39	NC
13	B1	40	NC
14	B2	41	VCC
15	B3	42	VCC
16	B4	43	YD
17	B5	44	XL
18	B6	45	NC
19	B7	46	NC
20	G0	47	NC
21	G1	48	NC
22	G2	49	NC
23	G3	50	NC
24	G4	51	NC
25	G5	52	ENB(DEN)
26	G6	53	GND
27	G7	54	AVSS

**BLAZE** Blaze Display Technology Co.,Ltd.

DISPLAY TYPE:	3.5" TFT	DISPLAY DRIVER:	HX8238-D	PIXEL PITCH:	0.219 X 0.219 mm
POLARIZER MODE:	TRANSMISSIVE	OPERATING TEMP:	-20°C TO +70°C	BACK LIGHT:	LED WHITE(X6), 串联
VIEWING DIRECTION:	6 O'CLOCK	STORAGE TEMP:	-30°C TO +80°C		
Dot matrix:	320(RGB)X240 DOTS	STRUCTURE:	LCD+IC+FPC+BL+TP	MATERIAL NOTE	ROHS REQUEST

DESIGNED BY:	BDT-23	BDT-T3554-03-SERIES	VERSION:	1.0
CHECKED BY:	BDT-09		PAGE	1 OF 1
APPROVED BY:	BDT-05		UNIT:	mm
Website: <a href="http://www.blazedisplay.com">http://www.blazedisplay.com</a>			DATE:	2013-08-01