

FPC INTERFACE

1	K
2	A
3	NC
4	VDD
5	R0
6	R1
7	R2
8	R3
9	R4
10	R5
11	R6
12	R7
13	G0
14	G1
15	G2
16	G3
17	G4
18	G5
19	G6
20	G7
21	B0
22	B1
23	B2
24	B3
25	B4
26	B5
27	B6
28	B7
29	GND
30	CLK
31	DISP
32	HSYNC
33	VSYNC
34	DE
35	NC
36	GND
37	XR
38	YD
39	XL
40	YU

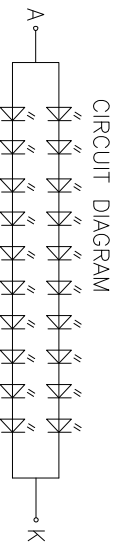
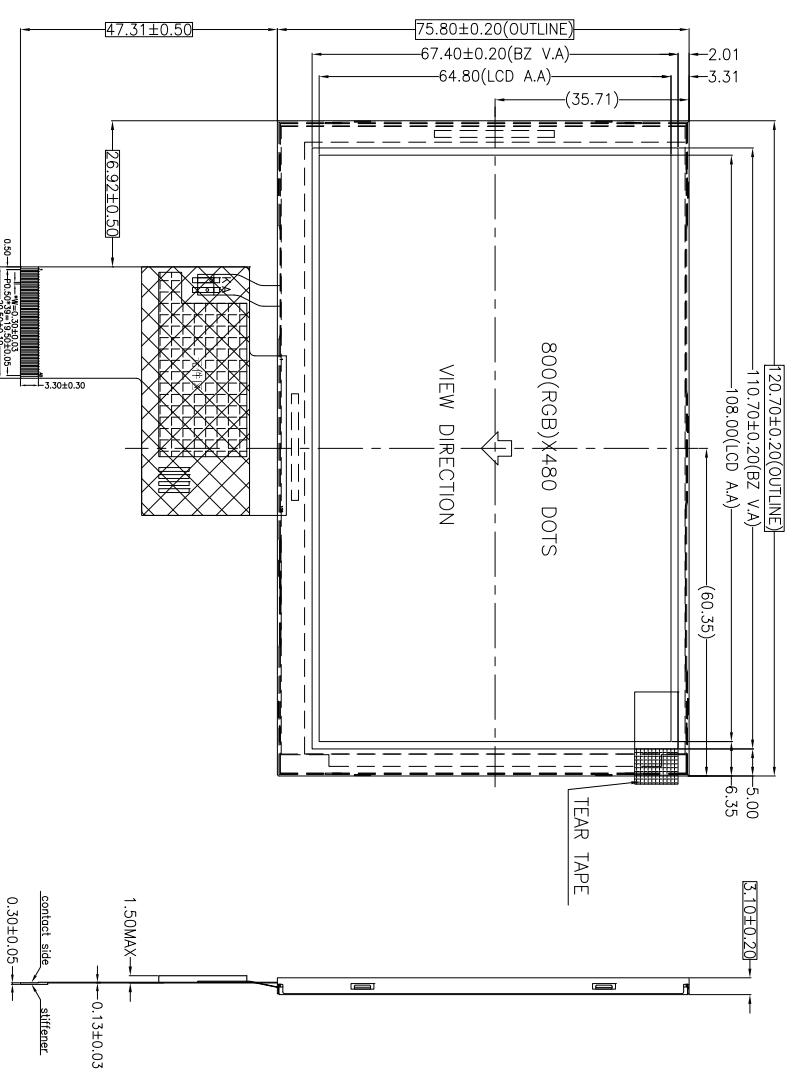

VF=31.0V±2.0V;IF=40mA

DISPLAY TYPE:	5.0" TFT	DISPLAY DRIVER:		PIXEL PITCH:	0.231 X 0.231 mm
POLARIZER MODE:	TRANSMISSIVE	OPERATING TEMP:	-20°C TO +70°C	BACK LIGHT:	LED WHITE(X20),10#2并
VIEWING DIRECTION:	12 O'CLOCK	STORAGE TEMP:	-30°C TO +80°C	MATERIAL NOTE	
Dot matrix:	800(RGB)X480 DOTS	STRUCTURE:	LCD+IC+FPC+BL+TP	ROHS REQUEST	

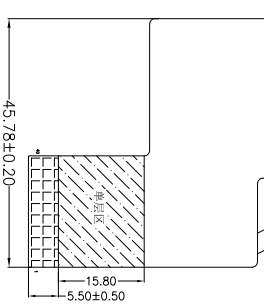
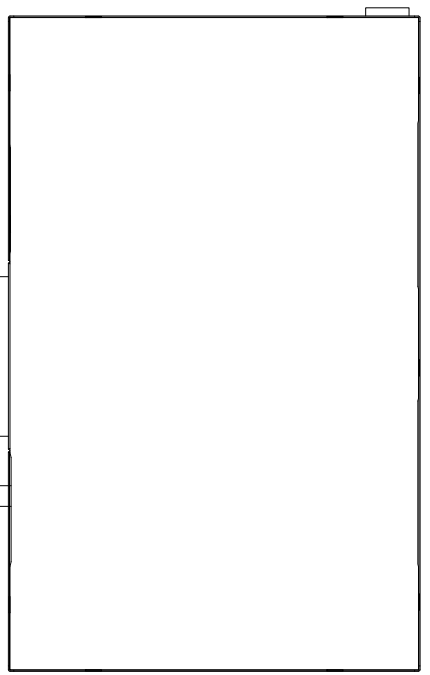

Blaze Display Technology Co., Ltd.

DESIGNED BY: BDT-23	BDT-15040-07-SERIES	VERSION:	1.0
CHECKED BY: BDT-09		PAGE	1 OF 1
APPROVED BY: BDT-05		UNIT:	mm
Website: http://www.blazedisplay.com		DATE:	2015-12-11