

Revised Record

1.0

New issue

2008-11-19

INTERFACE

1	VSS
2	VDD(5V)
3	V0
4	RS
5	E1
6	E2
7	R/W
8	DB0
9	DB1
10	DB2
11	DB3
12	DB4
13	DB5
14	DB6
15	DB7
16	RST
17	LED-A(5V)
18	LED-K

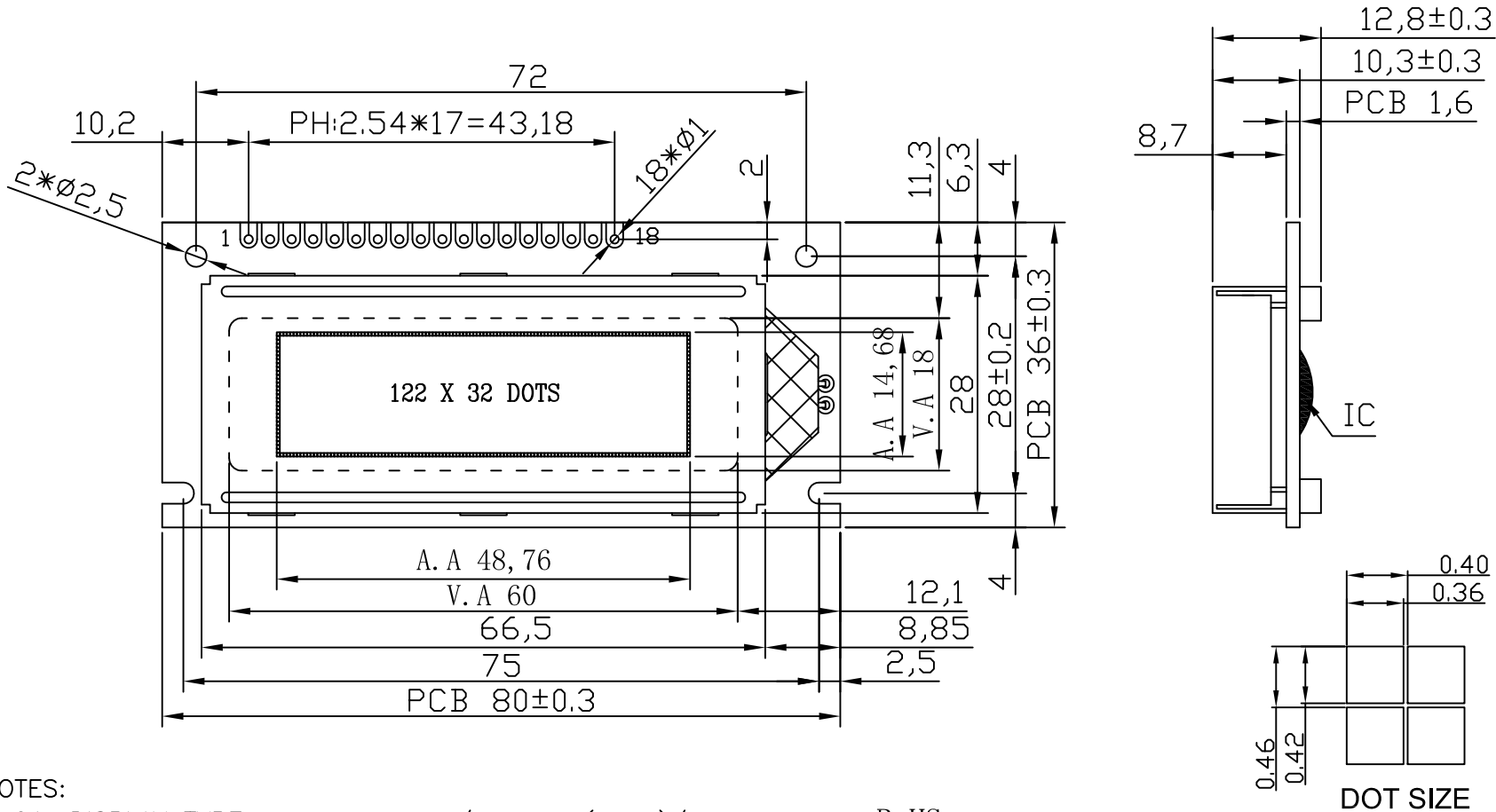

NOTES:

- 01. DISPLAY TYPE: STN/NEGATIVE(BLUE)/TRANSMISSIVE RoHS
- 02. OPERATING VOLTAGE: VOP=5.0V,VDD=5.0V
- 03. OPERATING TEMPERATURE: -20°C~+70°C
- 04. STORAGE TEMPERATURE: -30°C~+80°C
- 05. DRIVE MODE: 1/32DUTY,1/5BIAS
- 06. VIEWING DIRECTION: 6:00
- 07. DRIVE IC: SBN1661G
- 08. CONNECTOR: ZEBER
- 09. BACKLIGHT: LED(WHITE)
- 10. CUSTOMER'S PART ID: BLAZE_STANDARD_PRODUCT

BLAZE Blaze Display Technology Co.,Ltd.

DESIGNED BY: BDT-14

BGB12232-08-SERIES

VERSION: 1.0

CHECKED BY: BDT-09

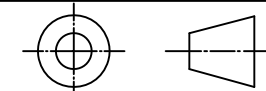

PAGE 1 OF 1

APPROVED BY: BDT-02

UNIT: mm

Website:<http://www.blazedisplay.com>

DATE: 2008-11-19