

Revised Record

1.0 New Issue

2016-08-08

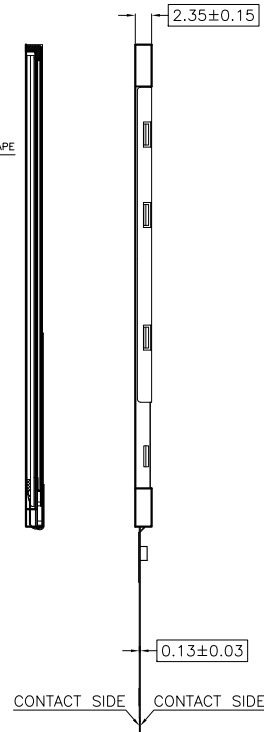
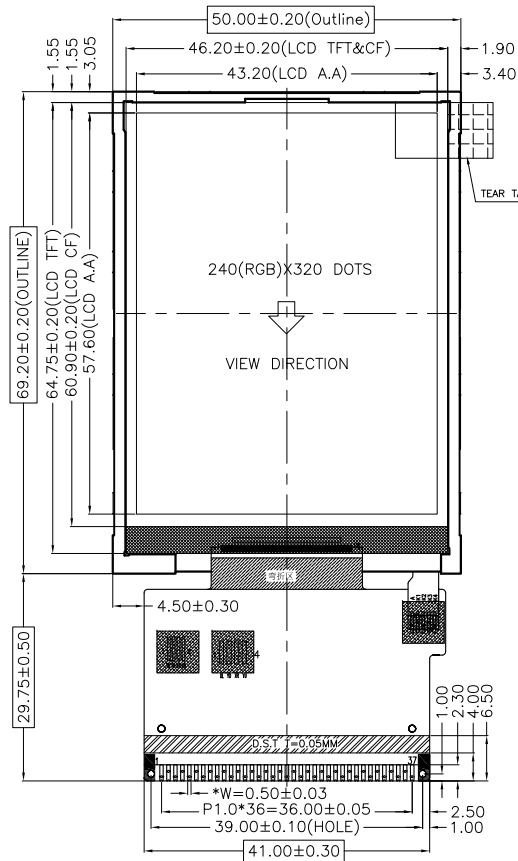

BACKLIGHT CIRCUIT DIAGRAM

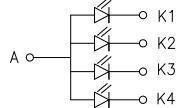

VF=3.1±0.2V;IF=15*4mA

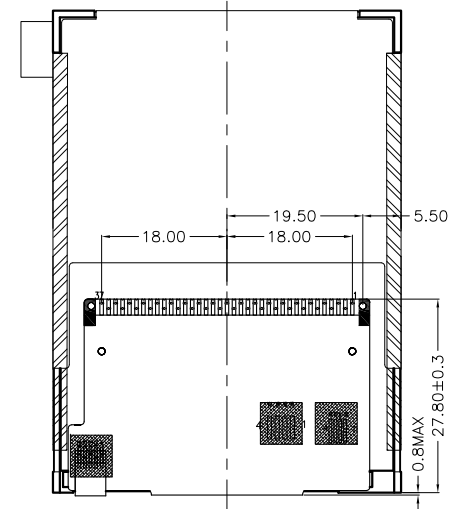
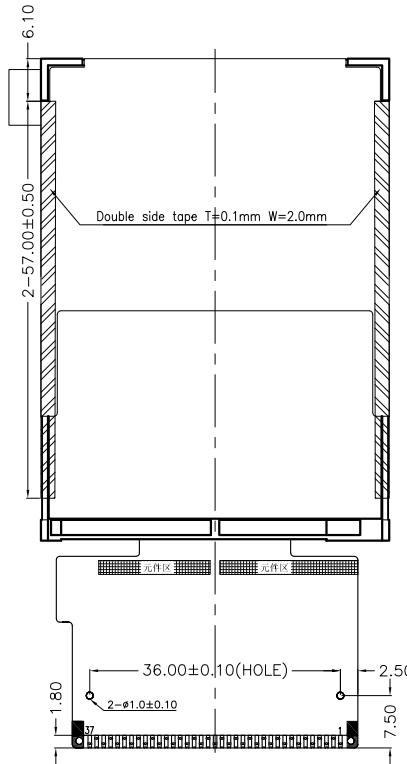

Bended FPC

8bit DB10~DB17
DB0~DB7 CONNECT VSS

FPC INTERFACE

1	DB0/GND
2	DB1/GND
3	DB2/GND
4	DB3/GND
5	GND1
6	VCC1
7	/CS
8	RS
9	/WR
10	/RD
11	NC
12	XR
13	YD
14	XL
15	YU
16	LEDA
17	LEDK1
18	LEDK2
19	LEDK3
20	LEDK4
21	NC
22	DB4/GND
23	DB10
24	DB11
25	DB12
26	DB13
27	DB14
28	DB15
29	DB16
30	DB17
31	/RESET
32	VCI
33	VCC2
34	GND
35	DB5/GND
36	DB6/GND
37	DB7/GND

DISPLAY TYPE:	2.8" TFT	DISPLAY DRIVER:	ILI9341V	PIXEL PITCH:	0.180 X 0.180 mm
POLARIZER MODE:	TRANSMISSIVE	OPERATING TEMP:	-20°C TO +70°C	LCM BRIGHTNESS (CD/M ²):	150MIN/180TYP
VIEWING DIRECTION:	12 O'CLOCK	STORAGE TEMP:	-30°C TO +80°C	BACK LIGHT:	LED WHITE(X4), 并联
Dot matrix:	240(RGB)X320 DOTS	STRUCTURE:	LCD+IC+FPC+BL	MATERIAL NOTE	ROHS REQUEST

BLAZE Blaze Display Technology Co., Ltd.

DESIGNED BY: BDT-23

BDT-T2837-04-SERIES

VERSION: 1.0

CHECKED BY: BDT-09

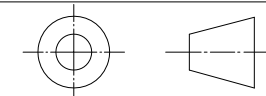

PAGE 1 OF 1

APPROVED BY: BDT-05

UNIT: mm

Website: <http://www.blazedisplay.com>

DATE: 2016-08-08