

FPC INTERFACE

1	K
2	A
3	GND
4	VDD
5	R0
6	R1
7	R2
8	R3
9	R4
10	R5
11	R6
12	R7
13	G0
14	G1
15	G2
16	G3
17	G4
18	G5
19	G6
20	G7
21	B0
22	B1
23	B2
24	B3
25	B4
26	B5
27	B6
28	B7
29	DGND
30	DCLK
31	DISP
32	HSYNC
33	VSYNC
34	DE
35	NC
36	GND
37	NC/XR
38	NC/YD
39	NC/XL
40	NC/YU

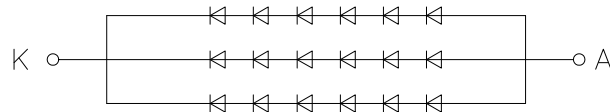

CIRCUIT DIAGRAM

VF=18.6V±1.2V;IF=60mA

电容屏接口定义

PIN NO.	DEFINITION
1	RST
2	VCC
3	GND
4	INT(1.8V)
5	SDA(1.8V)
6	SCL(1.8V)

BLAZE Blaze Display Technology Co.,Ltd.

DISPLAY TYPE:	5.0" TFT	DISPLAY DRIVER:		PIXEL PITCH:	0.231 X 0.231 mm
POLARIZER MODE:	TRANSMISSIVE	OPERATING TEMP:	-20°C TO +70°C	BACK LIGHT:	LED WHITE(X20),10串2并
VIEWING DIRECTION:	12 O'CLOCK	STORAGE TEMP:	-30°C TO +80°C		
Dot matrix:	800(RGB)X480 DOTS	STRUCTURE:	LCD+IC+FPC+BL+TP	MATERIAL NOTE	ROHS REQUEST

DESIGNED BY: BDT-23

BDT-T5040-08-SERIES

VERSION: 1.0

CHECKED BY: BDT-09

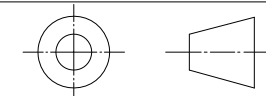

PAGE 1 OF 1

APPROVED BY: BDT-05

UNIT: mm

Website: <http://www.blazedisplay.com>

DATE: 2017-04-05