

Revised Record

1.0 New Issue

2015-03-24

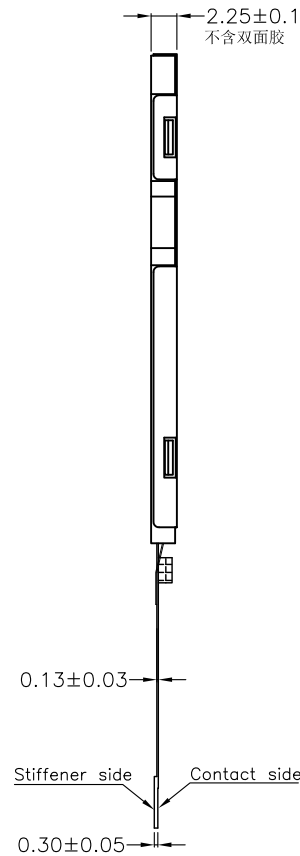
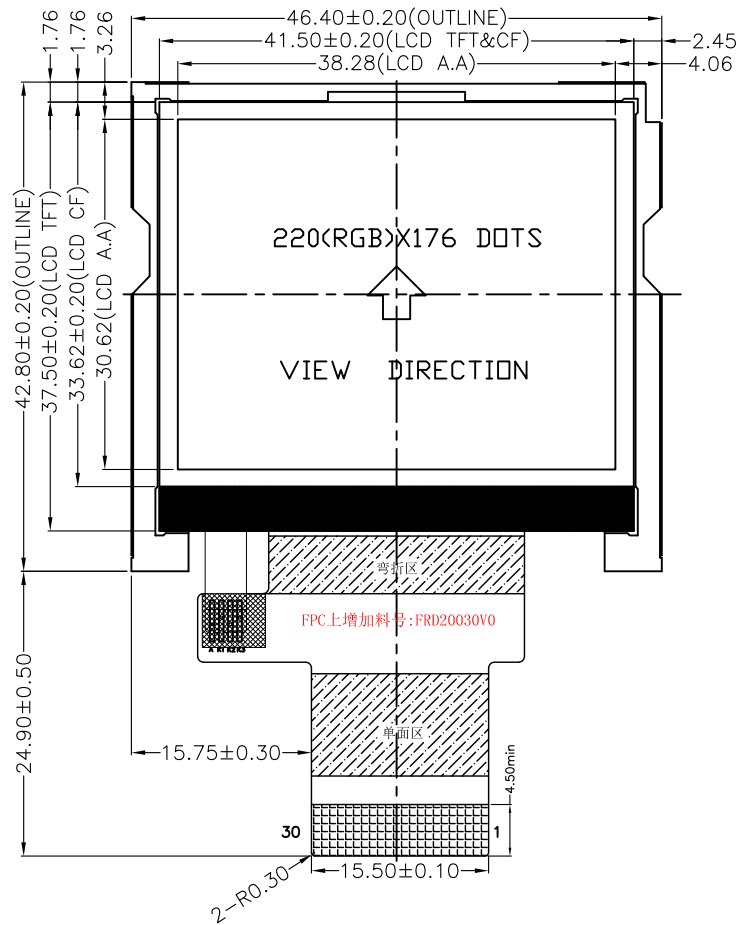

Circuit Diagram

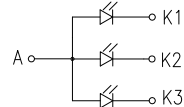

VF=3.2±0.2;IF=45mA

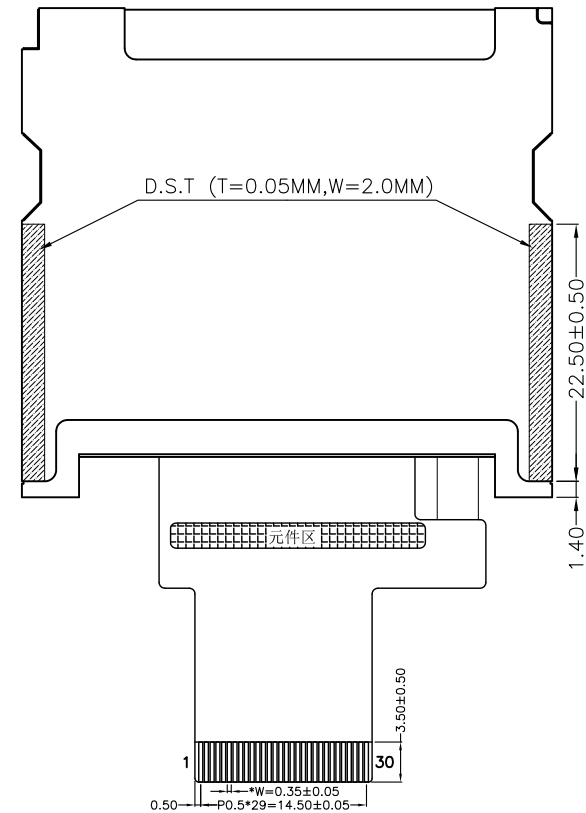

FPC INTERFACE

1	GND
2	VCC
3	IOVCC
4	RESET
5	CS
6	RS
7	WR
8	RD
9	D0
10	D1
11	D2
12	D3
13	D4
14	D5
15	D6
16	D7
17	D8
18	D9
19	D10
20	D11
21	D12
22	D13
23	D14
24	D15
25	TE
26	LED-A
27	LED-K1
28	LED-K2
29	LED-K3
30	NC

此款使用高8位和16位跳电阻兼容展开出货

BLAZE Blaze Display Technology Co.,Ltd.

DISPLAY TYPE:	2.0" TFT	DISPLAY DRIVER:	ILI9341V	PIXEL PITCH:	0.174 X 0.174 mm
POLARIZER MODE:	TRANSMISSIVE	OPERATING TEMP:	-20°C TO +70°C	LCM BRIGHTNESS (CD/M ²):	
VIEWING DIRECTION:	6 O'CLOCK	STORAGE TEMP:	-30°C TO +80°C	BACK LIGHT:	LED WHITE(X3), 并联
Dot matrix:	220(RGB)X176 DOTS	STRUCTURE:	LCD+IC+FPC+BL	MATERIAL NOTE	ROHS REQUEST

DESIGNED BY: BDT-23

BDT-T2030-01-SERIES

VERSION: 1.0

CHECKED BY: BDT-09

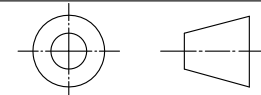

PAGE 1 OF 1

APPROVED BY: BDT-05

UNIT: mm

Website: <http://www.blazedisplay.com>

DATE: 2015-03-24